

RESOLUTION 2012-06-04-2

A RESOLUTION OF THE CITY COUNCIL OF THE CITY OF LLANO, TEXAS, AUTHORIZING THE ACCEPTANCE OF THE EASEMENT TRACT 1 (LIFT STATION) AND OF THE EASEMENT TRACT 2 (INGRESS/EGRESS) OUT OF A 20.00 ACRE TRACT OF LAND DESCRIBED IN DEED TO WILLIAM E. CROW.

WHEREAS, The City of Llano is in the process of completing the construction of the lift station of said Easement Tract 1, and of the ingress/egress of said Easement Tract 2;

WHEREAS, various landowners have donated property to the City; and

WHEREAS, the City has determined that it is in the public interest to accept the donation of easements and that such acts will promote the health, safety, welfare, and morals of the citizens of Llano; and

WHEREAS, the City has determined that this resolution was adopted at a regularly scheduled meeting of the Llano City Council where a quorum was present and that was held in strict compliance with the Texas Open Meetings Act;

NOW THEREFORE, BE IT RESOLVED THAT THE CITY COUNCIL OF THE CITY OF LLANO, TEXAS HEREBY ADOPTED THE FOLLOWING RESOLUTION:

The City of Llano hereby accepts the donation Easement Tract 1 (Lift Station) being "Exhibit A" being 1032 square feet of land situated in Llano County, Texas in the Daniel T. Fitchett Survey No. 220, Abstract No. 209 out of a 20.00 acres tract of land described in deed to William E. Crow in the Llano County official public records and Easement Tract 2 (Ingress/Egress) being "Exhibit B" a 20' wide ingress/egress easement (3996 sq. ft.) situated in Llano County, Texas, in the Daniel T. Fitchett Survey No. 220, Abstract No. 209 out of a 20.00 acres tract of land described in deed to William E. Crow in the Llano County official public records.

PASSED and APPROVED this the 4th day of June, 2012.





Mike Reagor, Mayor

ATTEST:

Toni Milam, City Secretary

**Fred L. Thompson
& Associates, P.C.**

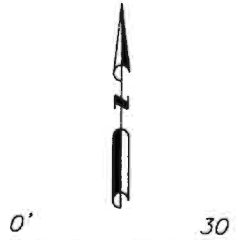
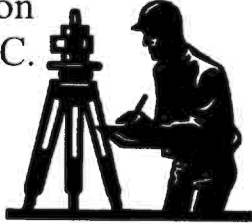
111 W. Main St.
P.O. Box 74
Llano, TX 78643
P: (325) 247-4510
F: (325) 247-1043
llanosurvey.com



SCALE: 1"=30'
BEARING BASIS IS WGS84

DANIEL T. FITCHETT

ONA RHODES, ET AL
VOL. 165, PG. 400
L.C.P.R.

ABST. NO. 209

20.00 ACRES
WILLIAM E. CROW
VOL. 1529, PG. 4117
L.C.O.P.R.

SURVEY NO. 220

LEGEND	
○	1/2" IRON ROD SET W/ RED CAP, "FLT ASSOC"
△	60D NAIL SET
■	TxDOT ROW MONUMENT
○	FENCE POST
▲	CALCULATED POINT
- x - x -	WIRE FENCE
P.O.B.	POINT OF BEGINNING
P.O.C.	POINT OF COMMENCEMENT
P.O.T.	POINT OF TERMINATION

LINE	BEARING	DISTANCE
L1	N 06°10'26" E	37.45'
L2	S 83°13'18" E	27.99'
L3	S 06°15'39" W	36.40'
L4	N 85°21'35" W	27.94'

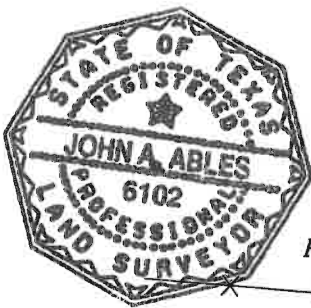

POC TRACT 1
& TRACT 2

SKETCH TO ACCOMPANY DESCRIPTIONS OF
TWO EASEMENTS FOR A CITY OF LLANO LIFT STATION

POB TRACT 2
TEXAS STATE R.M. HIGHWAY NO. 152
80' ROW 77/266 L.C.D.R.

I, JOHN A. ABLES, REGISTERED PROFESSIONAL LAND SURVEYOR # 6102 DO HEREBY CERTIFY THAT THIS PLAT WAS PREPARED FROM AN ON THE GROUND SURVEY PERFORMED UNDER MY SUPERVISION ON THE 30th DAY OF APRIL, 2012, WITNESS MY HAND AND SEAL THIS THE 9th DAY OF MAY, 2012.

JOHN A. ABLES R.P.L.S. #6102

LEGAL DESCRIPTION: TWO (2) EASEMENT TRACTS SITUATED IN LLANO COUNTY, TEXAS IN THE DANIEL T. FITCHETT SURVEY No. 220, ABSTRACT No. 209, OUT OF A 20.00 ACRE TRACT OF LAND DESCRIBED IN DEED TO WILLIAM E. CROW OF RECORD IN VOL. 1529, PG. 4117, L.C.O.P.R. TRACT ONE (1) BEING A 1032 SQ.FT EASEMENT FOR A LIFT STATION, TRACT TWO (2) BEING A 3996 SQ.FT INGRESS/EGRESS EASEMENT APPURTENANT TO SAID LIFT STATION
FIELDLED: 04/30/2012 CREW: BM & WT DRAFTED: 05/09/2012
BY: JAA JOB#: 12040502 REF:11050501,06032803 PAGE 1 OF 3

FRED L. THOMPSON & ASSOCIATES, P. C.
P. O. BOX 74 LLANO, TEXAS 78643-0074
325-247-4510 (O) 325-247-1043 (F)

(PAGE 2 OF 3)

EASEMENT TRACT 1
(LIFT STATION)

FIELD NOTES DESCRIBING 1032 SQ. FT. OF LAND IN LLANO COUNTY, TEXAS

BEING 1032 SQ. FT. OF LAND SITUATED IN LLANO COUNTY, TEXAS, IN THE DANIEL T. FITCHETT SURVEY No. 220, ABSTRACT No. 209, OUT OF A 20.00 ACRE TRACT OF LAND DESCRIBED IN DEED TO WILLIAM E. CROW OF RECORD IN VOLUME 1529, PAGE 4117, LLANO COUNTY OFFICIAL PUBLIC RECORDS BEING MORE PARTICULARLY DESCRIBED BY METES AND BOUNDS AS FOLLOWS:

COMMENCING at a fence corner post in the north line of Texas State Highway No. 152, an 80' wide right of way, of record in Volume 77, Page 266, Llano County Deed Records (L.C.D.R.), being the southeast corner of a tract of land described in deed to Ona Rhodes, et al., of record in Volume 165, Page 400, L.C.D.R., being the southwest corner of said 20.00 acre tract;

THENCE, N 06°10'26" E, with the east line of said Rhodes tract, and the west line of said 20.00 acre Crow tract, a distance of 199.85 feet to a ½" iron rod set for the southwest corner and **POINT OF BEGINNING** hereof;

THENCE, N 06°10'26" E, continuing with the east line of said Rhodes tract, and the west line of said 20.00 acre tract a distance of 37.45 feet to a ½" iron rod set for the northwest corner hereof;

THENCE, over and across said 20.00 acre tract the following three (3) courses and distances:

- 1.) S 83°13'18" E, a distance of 27.99 feet to a ½" iron rod set,
- 2.) S 06°15'39" W, a distance of 36.40 feet to a ½" iron rod set, and
- 3.) N 85°21'35" W, a distance of 27.94 feet to the **POINT OF BEGINNING** hereof, and containing an area of 1032 square feet of land, as surveyed by Fred L. Thompson & Associates, P.C. under the supervision of John A. Ables, Registered Professional Land Surveyor No. 6102.

This description is to be used in conjunction with the accompanying survey plat attached hereto and made a part hereof. Bearing basis for this description is based on World Geodetic System of 1984. All ½" iron rods set have a red plastic cap inscribed "FLT ASSOC".

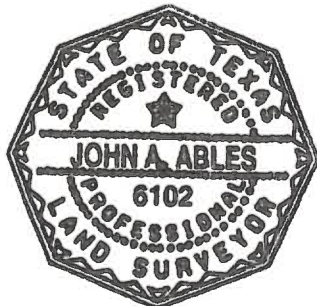

John A. Ables R.P.L.S. #6102
P. O. Box 74, Llano, TX 78643

5/9/2012
Date

12040502_T1
COPYRIGHT 2012
FRED L. THOMPSON & ASSOC., P.C.

Exhibit "A"

FRED L. THOMPSON & ASSOCIATES, P. C.

P. O. BOX 74 LLANO, TEXAS 78643-0074

325-247-4510 (O) 325-247-1043 (F)

(PAGE 3 OF 3)

**EASEMENT TRACT 2
(INGRESS/EGRESS)**

**FIELD NOTES DESCRIBING THE CENTERLINE OF A 20' WIDE
INGRESS/EGRESS EASEMENT (3996 SQ. FT.) IN LLANO COUNTY, TEXAS**

BEING A 20' WIDE INGRESS/EGRESS EASEMENT (3996 SQ. FT.) SITUATED IN LLANO COUNTY, TEXAS, IN THE DANIEL T. FITCHETT SURVEY No. 220, ABSTRACT No. 209, OUT OF A 20.00 ACRE TRACT OF LAND DESCRIBED IN DEED TO WILLIAM E. CROW OF RECORD IN VOLUME 1529, PAGE 4117, LLANO COUNTY OFFICIAL PUBLIC RECORDS, THE CENTERLINE OF SAID EASEMENT BEING DESCRIBED AS FOLLOWS:

COMMENCING at a fence corner post in the north line Texas State Highway No. 152, an 80' wide right of way, of record in Volume 77, Page 266, Llano County Deed Records (L.C.D.R.), being the southeast corner of a tract of land described in deed to Ona Rhodes, et al., of record in Volume 165, Page 400, L.C.D.R., being the southwest corner of said 20.00 acre tract;

THENCE, S 85°34'14" E, with the north line of Highway No. 152, being the south line of said 20.00 acre tract, a distance of 15.45 feet to the southerly point and **POINT OF BEGINNING** hereof, from which a concrete highway right of way monument bears S 85°56'55" E, 11.98 feet;

THENCE, N 06°08'56" E, a distance of 199.79 feet to a 60d nail set in the south line of an easement surveyed this date called Tract 1, for the most northerly point and **POINT OF TERMINATION** hereof, from which a ½" iron rod set for the southeast corner of said Tract 1 bears S 85°21'35" E, a distance of 12.57.

Surveyed by Fred L. Thompson & Associates, P.C. under the supervision of John A. Ables, Registered Professional Land Surveyor No. 6102.

This description is to be used in conjunction with the accompanying survey plat attached hereto and made a part hereof. Bearing basis for this description is based on World Geodetic System of 1984. All ½" iron rods set have a red plastic cap inscribed "FLT ASSOC".



John A. Ables R.P.L.S. #6102

5/9/2012
Date

P. O. Box 74, Llano, TX 78643

12040502_T2
COPYRIGHT 2012
FRED L. THOMPSON & ASSOC., P.C.

Exhibit "B"