

Attention Local Residence

The City of Llano will be Closing the following streets to Local Residence traffic ONLY.

East Main Street @ Oatman Street

East Sandstone Street @ Hickory Street and all side street going to East Sandstone will be closed to thru traffic on East Luce Street from Elm Street to Mulberry Street.

If you live on Main Street you can still access you home through the road closed barricades.

If you live on East Sandstone Street beyond Hickory Street, you will need to detour to East Luce Street and access you home from the nearest side street.

These closures are in effort to reduce dust on Sandstone Street and increase safety for the crews working. If you have any question or concerns, please contact City Hall at 325-247-4158.

We have attached a map on the reverse side to assist in you planning a route home.

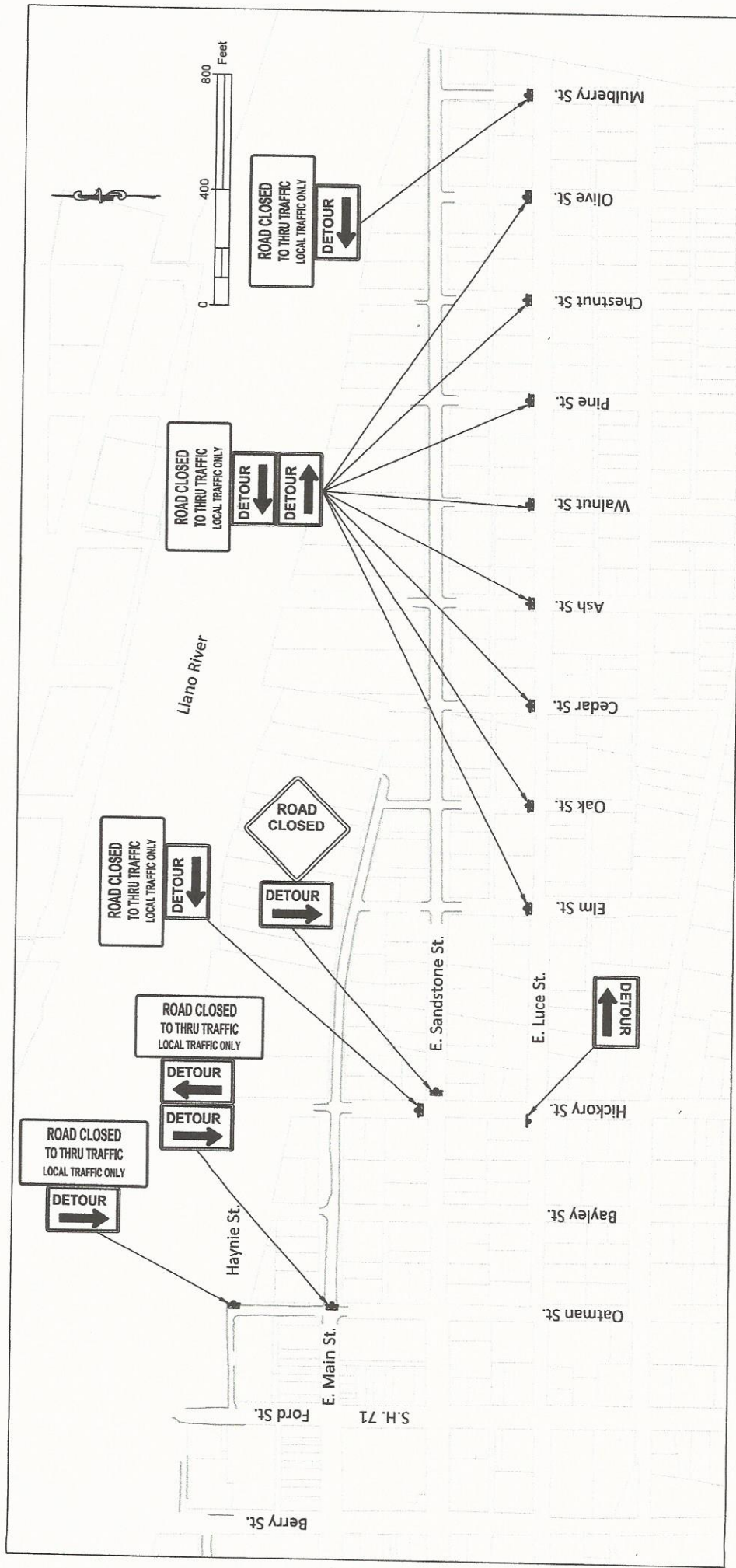

LLANO STREET CLOSURE MAP

SCALE: 1" = 400'